



## Owner's Manual

Rev: 8.25103

Thank you for purchasing a ProVari Radius personal vaporizer.  
We hope you get many years of enjoyment from this device.

[www.ProVape.com](http://www.ProVape.com)

### Introduction

A personal vaporizer (PV) is a battery-powered device that provides inhaled doses of nicotine by way of a vaporized solution. In addition to the nicotine delivery, this vapor also provides a flavor and physical sensation similar to that of inhaled tobacco smoke. Vaporizers do not contain tar and have just a few ingredients compared to several thousand found in traditional cigarettes. There is no tobacco or combustion involved in its operation. There is no ash and no smell. Vaping is the 21st century alternative to smoking tobacco products. Just please keep in mind that personal vaporizers are not meant to be a smoking cessation device. This device can also be used without nicotine.

The ProVari Radius featuring the ProVape Radius chip is a powerful microprocessor controlled PV that lets you adjust and fine tune the device to your exact preferences by adjusting the wattage, along with a number of other parameters which we will explain later in this manual. The ProVari Radius uses the latest technology to bring you some new and exciting features. The ProVari Radius has regulated power output which keeps the wattage the same with each puff regardless of your remaining battery power. As the battery drains, the device will keep the power output consistent, giving you the perfect vapor all day long. Now you can dial-in the perfect settings for your tank or atomizer and e-liquid!

**(Please note that due to ongoing software updates, improvements and changes based on customer feedback, some of the features or screen images shown in this manual may be slightly different)**

## Table of Contents

|  |    |
|--|----|
| Introduction .....                                       | 1  |
| Warnings .....   | 3  |
| ProVari Radius Features .....                            | 4  |
| ProVari Radius Feature Details .....                     | 5  |
| ProVari Radius Components .....                          | 8  |
| ProVari Radius Adapter.....                              | 9  |
| Batteries .....  | 9  |
| Charging a Battery Using a Standard Battery Charger..... | 9  |
| Charging a Battery Using the Built-in Charger .....      | 10 |
| Inserting a Battery .....                                | 10 |
| Menu Flow Chart.....                                     | 11 |
| Push Buttons.....  | 12 |
| Screen Layout.....                                       | 13 |
| Check All/Status Screen.....                             | 13 |
| Warning System.....                                      | 14 |
| Menu Options and Functions .....                         | 15 |
| Money Saved Counter - Cigarette Counter .....            | 24 |
| Error Messages and Fixes .....                           | 25 |
| Error Message Details.....                               | 25 |
| Radius Energy Gauge.....                                 | 27 |
| Additional Warnings.....                                 | 29 |



## Warnings:

- Never abuse your ProVari Radius. Even though it's durable, you can do damage by dropping it.
- Have your ProVari repaired by ProVape. Do not attempt to repair the unit yourself as damage or personal injury can occur. Any repairs done outside of ProVape will void the warranty.
- Do not remove the circuit board. Doing so will void your warranty.
- Remove the battery from the ProVari Radius if you plan to store it for long periods of time.
- The ProVari Radius operates on a single battery. NEVER stack two batteries or use batteries that are not recommended for use in the ProVari Radius. Never use magnets on your batteries. This is very dangerous.
- ProVape will not be responsible for damaged atomizers or tanks. Driving them with too much power for too long or running them dry can burn them out. We recommend you start with a low wattage setting and work your way up until you find the right power setting for your atomizer/tank.
- NEVER use primary or non-rechargeable batteries in this device. Only use recommended high drain rechargeable batteries. If you are unsure about which batteries to use, please contact us or purchase your batteries from [www.ProVape.com](http://www.ProVape.com) to ensure you use the correct cells. ProVape is not responsible for any kind of battery failure including misuse, overcharging cells or using a damaged cell. The ProVari Radius is a single battery device and only uses 1 rechargeable 18650 battery.
- Keep your ProVari Radius away from sources of excessive heat.
- Keep this device and all nicotine-related products out of reach of children and animals. Never drink the nicotine fluid. Never leave bottles of E-liquid out where children can access them.
- ALWAYS store your batteries in a plastic battery case. Never put batteries in your purse, pocket or other locations where coins, keys and other metal objects can touch together and cause a short. This could cause the battery to catch fire.
- If a battery deforms, begins leaking or smells funny, dispose of it properly. Wash your hands after handling leaky batteries. Do not get the battery fluid in your eyes! If you do, seek medical attention immediately.
- Never use your ProVari Radius without an atomizer. Do not connect to a volt meter without a resistive load. High voltages without a resistance can damage the device and will void your warranty.



**Do not pour alcohol into the ProVari Radius. This can damage the display and will void the warranty. If you have any problems, please contact our customer service team for assistance: <https://provape.zendesk.com/home>**

## ProVari Radius Features

- The ProVari Radius wattage can be adjusted from 3 – 40\* in 0.2 watt increments.
- Flat top design provides a clean hybrid look with the latest tanks.
- Self-adjusting center contact pin ensures maximum compatibility with tanks and atomizers.
- The new P3 thread is a unique top connection which allows you to adapt multiple tanks including 510, Ego and P3 threaded tanks. As new tank connections become available, the Radius will be able to adapt with screw-in adapters. Ego style adapters will be sold separately. As new tanks are developed with the P3 thread, they can be utilized, providing a clean hybrid look. 510 connection included.
- Built-in sealed OLED display with scrolling icon-based graphics allows you to visually adjust your settings.
- Three button design allows you to quickly adjust your power settings with the + / - buttons.
- Each device has a unique eighteen-digit serial number.
- A translucent seven color lighted push button allows you to select from seven color choices when the button is pressed. There is also a random and disco option which rotates through all seven colors each time you press the button.
- On/Off mode allows you to shut the unit off completely.
- Safety cutoff turns off the unit if the button is held down for too long.
- HotShot™ Boost mode allows you to get more vapor with a short power boost with each puff. This setting is adjustable allowing you to dial-in your favorite boost time setting.
- Scrolling OTS (Onboard Troubleshooting System) keeps the user informed of any problems and how to resolve them with clear instructions.
- Sub-ohm capability sets the limit by amperage. You can use .3, .4, .5 ohm tanks, limited to 9.5 amps. At .5 ohms you can power the unit to a full 40 watts.
- Amperage limit of up to 9.5 amps \* will protect against over-current situations.
- Battery gauge tells you how much energy is available to the atomizer.
- Smart safety features provide the highest levels of safety available on any device in the world. If you press the button and can vape, the device is safe!
- Thermal monitoring shuts the device off if it detects a high temperature condition in either the device or the battery.
- Left & right-handed mode allows the user to select which way the display reads.
- Check All mode allows the user to see all their critical settings at a quick glance with one button press (adjustable setting).
- Save profile. Save all of your favorite settings into 5 available memory slots for quick recall. Your settings will stay intact even if your battery is removed and/or the unit is updated.

- Scroll speed adjust allows the user to select the speed of the scrolling menu.
- OLED brightness adjustment lets you vary the display intensity.
- Multi-button combinations allow for shortcuts. Holding all three buttons down for three seconds turns the device on and off. Holding the two small buttons down for three seconds locks or unlocks the power adjustment.
- Exclusive reliable and safe electronic switch is designed for long life.
- Battery Monitoring shuts the unit off once a battery has reached end-of-charge.
- Reverse battery protection keeps the circuit safe if the battery is accidentally installed backwards.
- Built-in USB quick charging. Plug in to any USB port to top off your battery with the built-in quick charger. This USB port is also used to update the firmware when new features are available.
- The ProVari Radius is compatible with flat top batteries.
- No compromise components ensures a high quality and reliable device.
- Proudly made in the USA.
- 1 Year Warranty: Excludes accessories like batteries and atomizers.
- 3.4" L x 1.7" W x 1.0" D without atomizer.

\* Limits - The ProVari Radius will go down to .5 ohms and up to 40 watts. It's also capable of running lower ohm tanks but the unit is then limited to 9.5 amps. As an example, you could run .4 ohms up to 36 watts.

If the Radius detects you are using a battery that cannot handle the power output, it will limit the output to something that is safe. Please note that due to safety being our number one concern, there are limits set to prevent a dangerous situation.

## ProVari Radius Feature Details

- The ProVari Radius wattage can be adjusted from 3 – 40 \* in 0.2 watt increments. This feature allows the user to select their power level in wattage.

**Note: The lower the resistance on your atomizer and the higher the power setting, the more energy you are going to consume. This will likely reduce your battery run time.**

- Built-in OLED display with scrolling icons allows you to visually adjust your settings. This feature brings a full graphic experience to the user allowing you to adjust your settings with an innovative scrolling menu. Later on in this manual we will explain all the different options. While it looks complicated to use, it's actually fun and easy. After spending a little time with the new ProVari Radius menu, you will find it's easy to make changes and adjust your settings to customize the device to your liking.
- Three button design. With the additional two buttons, you can quickly adjust your power level up or down using these dedicated controls. You can also lock and unlock power adjustment by holding the + and - buttons down for three seconds, or if you hold all three buttons down together for three seconds, it

will turn the device on/off.

- The translucent seven color lighted push button allows you to select from seven color choices when the button is pressed. In the menu, there is an option where you can select from seven different colors for the lighted push button: red, green, blue, aqua, yellow, pink or white. There are also two random options so every time you press the button, the color changes. When you press the button to heat up the atomizer, the button will glow in the color you select. When the battery is depleted and needs to be recharged, the light will flash red. This red flashing LED color cannot be changed but as soon as you charge your battery, this will no longer flash.
- On/Off Mode allows you to shut the unit off completely. This feature is helpful for when you want to store the device and don't want it to accidentally turn on while it's in your pocket or purse. Anytime a new battery is installed, the device will default to ON mode even if the device was previously turned off.
- The safety cutoff turns off the unit if the button is held down for too long. This safety feature ensures that the device automatically shuts down if it detects the button is being held down.
- HotShot ® Boost mode allows you to briefly pre-heat your coil and get more vapor with each puff, removing the need to take pre-puffs. This setting is adjustable, allowing you to dial-in your favorite boost time setting. Boost mode is useful for those who want to heat up the atomizer faster. With Boost mode turned on, the atomizer will get a boost of power for a short period of time and then the power will drop down to your set power. For example, if you set your wattage to 10 watts and then turn on the boost mode to 1, by pressing the button, the device will boost the power for the first .25 seconds and then it will drop it down to 10 watts. Increasing the boost level to 2, 3, 4 or 5 will increase the amount of time the device boosts the power before it drops down to your selected 10 watts. Note that turning the ProVari Radius up to max wattage and boosting up to 5 will not exceed the maximum output of the unit which is up to 40 watts. Boost works up to 35 watts, but anything over 35 watts will only boost to a max of 40 watts for the selected time.

Boost 1 - .25 seconds  
Boost 2 – .50 seconds  
Boost 3 – .75 seconds  
Boost 4 – 1.00 seconds  
Boost 5 – 1.25 seconds

- The OTS keeps the user informed if there is a problem with the unit and instructs you on how to resolve the issue with clear instructions. If there is a problem detected, the ProVari Radius will display the error on the screen along with a recommended fix.
- The battery gauge tells you how much energy is available to the atomizer. This new approach is a little different than a typical battery percentage meter. Most percentage meters, like on your cell phone, “count down” so the battery level is always going down until you reach 0%. The ProVari Radius works more like an average mileage calculator on a car. As you speed up (or raise your power level), the miles per gallon will go down because you are using more fuel. As you slow down (lower your power level), the miles per gallon go up. This is a much more accurate way of telling the user how much energy is left in the battery for the atomizer to use. This number changes based on the power level you have the Radius set to along with your style of vaping. You will notice that this percentage will adjust as you change settings and it's perfectly normal for it to go back up as the battery recovers between uses. When you first insert your battery, you will see two question marks: ???. This simply indicates the Radius is evaluating the battery and after 1-2 puffs, it will update the status of the battery. When the battery runs out, the device will alert you with an “Empty” alert on the screen and the LED will flash red. At this time, recharge the battery.
- Smart safety features built-in provide the highest level of safety available. Our primary mission is safety.
- The Amperage limiting system protects against over-current situations. The ProVari Radius is capable of outputting up to 9.5 amps. If you want to use the ProVari Radius at maximum power, you will need to

ensure you use the approved batteries sold by ProVape or use the battery that came with your device. If you install a battery that cannot safely handle the full power output, the ProVari Radius will not allow the device to work at those levels and the power limit will be reduced. Our number one mission is safety. If you use a subpar battery that can be damaged or if that battery is not capable of handling that kind of output power, the ProVari will prevent damage to the device and the user. Please check with our Customer Service team for recommendations on batteries. We are always testing new cells and looking for a better battery to suggest to our customers.

- Thermal monitoring shuts the device off if it detects a high temperature condition in either the device or the battery. If the ProVari Radius detects that the internal temperature is reaching a dangerous level, it will turn off the device and internal charger. Then it will alert you on the screen that you need to remove the battery and let the device cool down before using it again.
- Left & right-handed mode allows the user to select which way the display reads. This cool new feature allows the user to select if they want to flip the screen for left or right-handed operation.
- Check All mode allows the user to see all their critical settings at a quick glance (adjustable settings). The Check All feature shows an at-a-glance screen when you press the button once. This shows you the remaining power left in the battery, the atomizer resistance, and your power level. You will also get a resistance reading on the installed atomizer. If the atomizer is not installed or there is a problem with the atomizer, you will get an OP reading meaning OPEN. The device does not see the atomizer installed when this appears. Try changing out the coil or atomizer and try again. The check all menu can be turned off and you can also adjust the amount of time it appears on your screen every time you press the button once. See below for how to change these settings.
- Save profile. Save all of your favorite settings into 5 available memory slots for quick recall. The Save and Recall option is a unique new feature which allows you to setup the device with your favorite settings and then save them for easy recall later. While the device will always remember your settings, even when changing batteries, the Save and Recall allows you to have lots of different settings for easy recall. Let's say you have a vanilla flavored fluid you like at 9 watts and you want the LED color to be white when using this setup. You would simply setup the ProVari Radius with all these settings and then go into the menu and select SAV to profile 1. Now let's say you like a cinnamon flavored fluid at 9.6 watts and want a red LED. You would setup those parameters and then go to the SAV to profile 2 in the menu. Now that you have two profiles saved, you can simply go to the recall menu and select which profile you want to load. This will display all your preferred settings quickly.
- Scroll speed adjust allows the user to select the speed of the scrolling menu. The default scroll speed is set to 2. Once you become familiar with the menu system, you may find that the default speed is too slow. When you are ready to increase the speed at which the menu items go by, you can access the scroll speed menu to change this speed. We recommend going to 3 and seeing how that works for you before turning it all the way up to 5.
- The OLED brightness adjustment allows you to adjust the brightness of the display. Note that with OLED technology, if you set the brightness all the way to high, the display won't last as long as if it's turned down. While we expect you to get many years of enjoyment out of the ProVari Radius, this setting can affect the life of the internal display.
- Reverse battery protection keeps the circuit safe if the battery is accidentally installed backwards. The ProVari Radius has a built-in reverse battery protection. If you install the battery backwards, it will not turn on. Simply install the battery properly to get power. The Radius is compatible with flat top batteries.

## ProVari Radius Components

Tanks, cartomizers and atomizers screw into the top plate (1).

Make sure you load these devices with your fluid of choice before attempting to use the Radius.



**The top plate (1) is permanently attached to the device. Do not attempt to remove it.**

The main Button (2) activates the heating element inside the tank which creates the vapor.

This button is also used to change the user settings on the ProVari Radius. The two smaller buttons are used to change power settings. There are some shortcuts to turning the device on/off and locking the adjustment of power using these smaller buttons. We will review these later in this manual.

Main Body (3)

The End Plate (4) is removed to install the battery. The Radius was designed to be charged and updated through the Micro-USB port (7). Should you ever need to change the battery, it is accessed by removing the End Plate.

Refer to the Battery instructions for more information about charging and installing a battery.

The Window (5) shows the Wattage settings, battery power and other modes as well as error codes in the event of a malfunction.

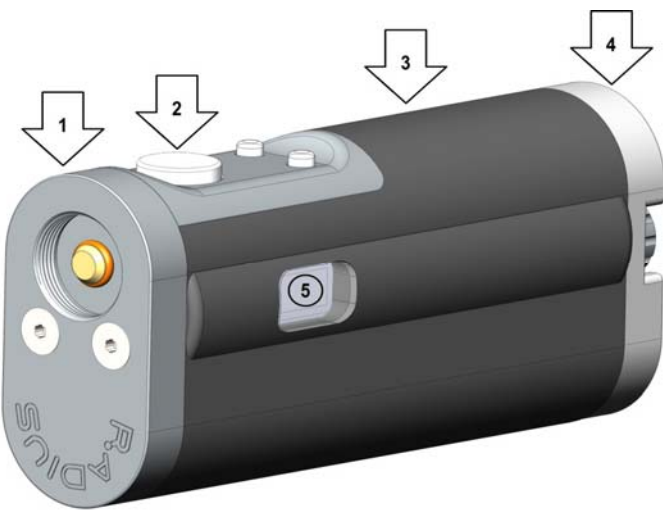

The bottom plate is held in place with two thumb screws (6). To access the battery, remove these two screws and you can replace the battery when needed. Never tighten the thumb screws too tight when installing.

USB Charging and PC software updates (7) This MicroUSB port is used to charge your device and update the internal software as new updates are available.

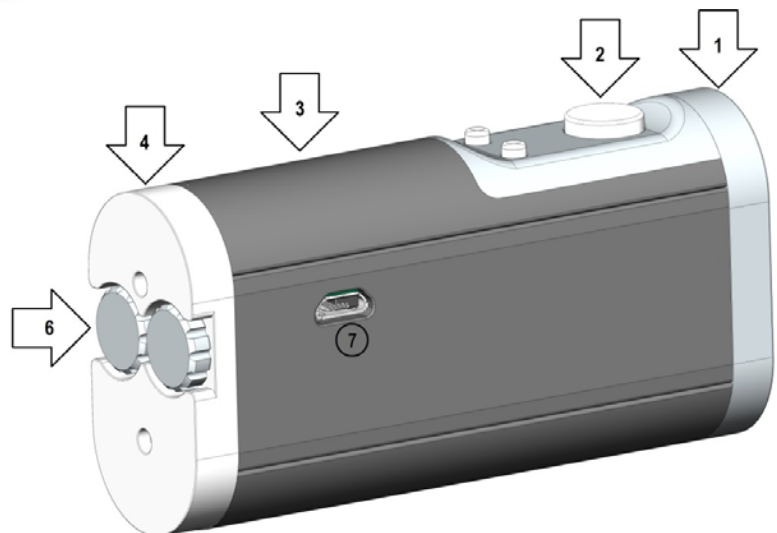



## ProVari Radius Adapter

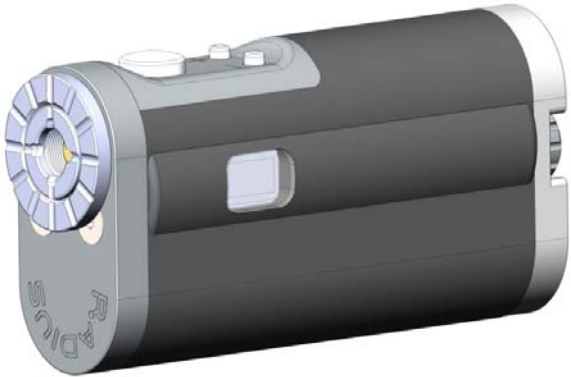

The ProVari Radius features a new standardized thread (P3 thread) which allows the user to easily switch between 510-style threads, Ego-type threads and any new hardware equipped with properly designed P3 threads. On the top of the 510 thread we have added coin slots so you can tighten the connector using a penny or dime. It's best to tighten this connector so it does not come off when you remove your tank.

Not only is the P3 thread stronger and more robust than most other attachment systems available, it also features specially designed adapters to allow the use of virtually any atomizer, tank or cartomizer available on the market today. By setting a new thread standard with the P3, future innovations can be adapted for use on the ProVari as well!

## Batteries

We recommend you only use IMR high drain batteries in this device. This will give you the full range of output power needed to use the device. Only use approved batteries. Always feel free to contact us if you are not sure which batteries to use. To ensure you get the correct batteries, you should always purchase them from an Authorized ProVape dealer or online at [www.ProVape.com](http://www.ProVape.com). The ProVari Radius has the ability to detect what type of battery you have inserted and if that battery is capable of providing adequate power to the unit. If you use a poor quality battery, the ProVari Radius will reduce the output power to match what the battery is capable of safely providing. If you plan to store the Radius for more than 10 days, we recommend you remove the battery or plug-in to charge. If the battery remains in the device for more than 10 days without being charged, it will slowly drain to empty and this may damage the cell to a point where it cannot be recharged.



**The ProVari Radius operates on a single battery. Never stack two batteries.  
Never use batteries that are not recommended for use in the ProVari Radius.  
Never use magnets on your batteries as this is very dangerous.**

## Charging a Battery Using a Standard Battery Charger

Plug the charger unit into an appropriate power supply.  
Insert a battery into the charger and make sure you put the battery in the correct direction.  
Align the positive (+) end of the battery with the positive (+) mark on the charger.  
The LED on the charger will glow red when the batteries are charging.  
The LED on the charger will glow green when the batteries are charged.  
(This could vary depending on the charger that you purchased)



**Do not attempt to charge other types of batteries in the battery charger. The ProVari uses a special kind of battery. Only use approved rechargeable cells. NEVER use alkaline batteries and never try to charge an alkaline battery.**

## Charging a Battery Using the Built-in Charger



The side of the device has a port where you can plug in the micro USB plug. This plug will insert into the device only one way. When the device is plugged in and charging, you will see a lightning symbol inside the battery icon showing that it's charging. Once it reaches full charge, the lightning bolt indicator will no longer appear.

Be careful when inserting the cable. Forcing or breaking this connection by inserting the wrong cable or abusing the connector by forcing the plug is not covered under warranty. When plugged into the onboard USB charger, your battery will begin charging. You can continue using the device while it's plugged in but the USB cable will not supply enough power to act as a pass-through, using your battery energy when you vape. When the device is idle, it will continue charging the cell inside. We have tested a number of USB battery packs and these all work great for charging your device while on the road. You can get these items from your local electronic store or from Amazon.

## Battery Life

When the battery is depleted, the battery icon on the screen will indicate that it's time to recharge. At this time recharge the battery.

## Inserting a Battery

The Radius was designed to easily charge the unit's battery by plugging a Micro USB cable on the side of the unit. Should you need to replace the battery however, it can be easily serviced at home. On the bottom of the unit, there are two thumb screws. Remove these two screws and the bottom plate can be removed. Once the plate is removed you will have access to removing the battery and installing a new cell. Note, there is a small metal tab that sits between the battery and the spring. Once the new battery is installed, make sure this metal tab rests on the bottom of the battery, then position the bottom plate onto the housing with the spring pressing on the metal tab. Install the two screws and you are ready to vape with a new battery. This whole process takes less than 40 seconds. We've designed the Radius with a metal plate that covers the bottom end of the battery to ensure you get the best possible battery connection. This increases your run time and gives you optimum battery performance and longevity.

When assembling the unit, do not over-tighten the screw. They should be snug, but not so tight that you won't be able to remove them when you need to replace the battery.

### Questions? Problems?

If you have any questions or problems with your ProVari Radius, please feel free to contact us or visit the retail location where you purchased your device. To contact ProVape, visit [www.ProVape.com](http://www.ProVape.com) and click on the "Contact Us" link.

© Copyright 2015 ProVape, Inc.

## Menu Flow Chart

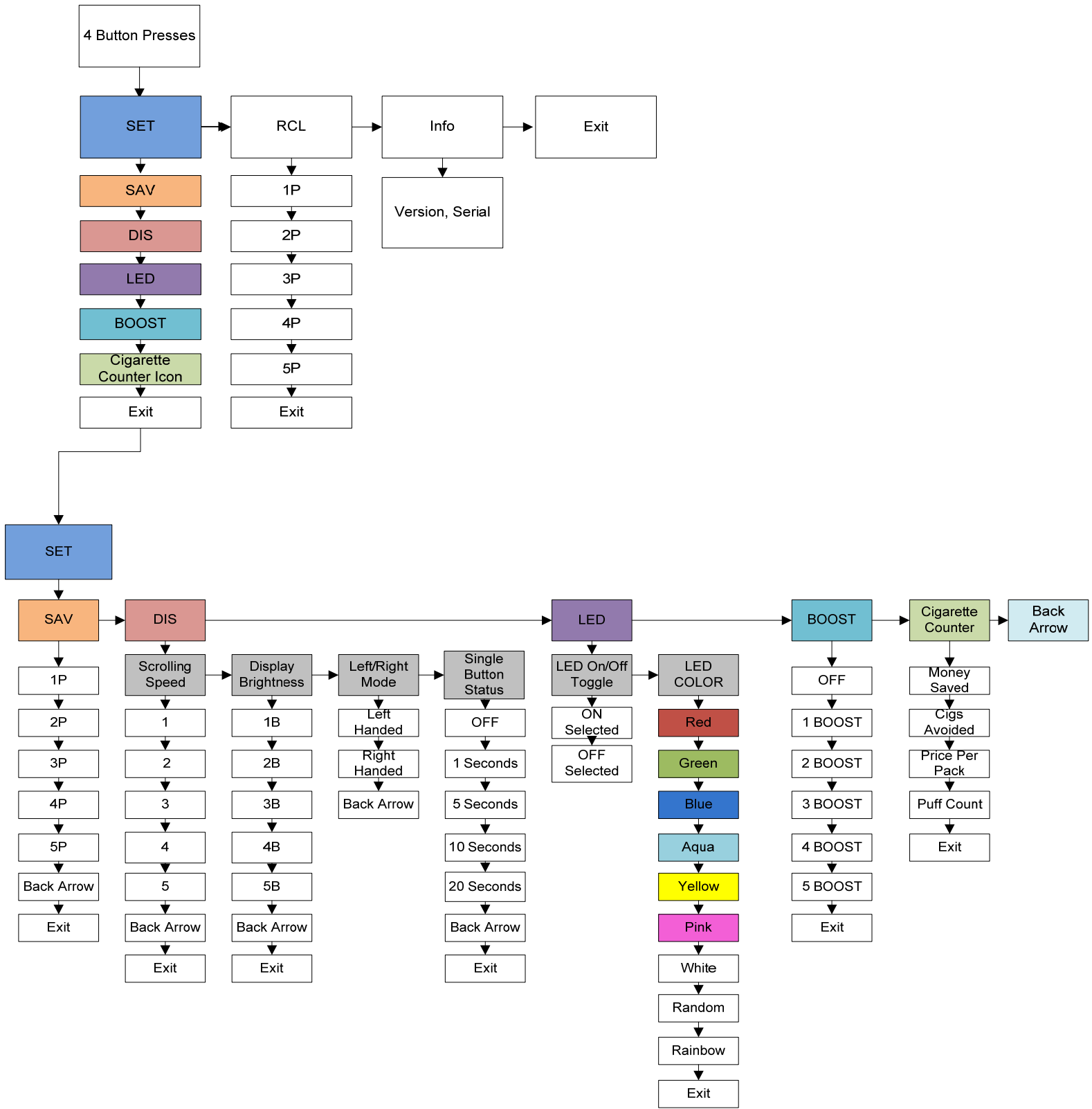

Note: Menu items can change slightly due to new features or ongoing improvements.

## Push Buttons



The ProVari Radius has three buttons located on the front of the unit. The large main button is used to power the device when vaping. It's also used to get into the menu to change settings by pressing it 4 times in a row.

There are also two smaller buttons labeled **+** and **-**. These are used to adjust the wattage up and down.

There are also some extra features assigned to these buttons for turning the device on/off and for locking the power adjustments.

**On/Off (Atomizer)** – Turning the atomizer on/off is done by holding all three buttons down at the same time for 3 seconds. Every time you hold these three buttons, the device will toggle back and forth between ON and OFF. You can also hold down all three buttons to continuously cycle between On/Off. In the event you will be storing the device in a pocket or purse and you do not want the fire button to accidentally get pressed, you can set this to OFF. The atomizer will not fire until you turn this back on or you remove the battery and reinstall, which will reset this back to ON.

Once you have selected the Atomizer ON/OFF option, the next screen will confirm your selection.



### Lock/Unlock

To prevent your power settings from being changed while storing the device in your pocket, you can lock and unlock the device. Hold the **+** and **-** buttons for three seconds until the Lock symbol appears on the screen. Repeat these steps to unlock and the device will show an unlocked symbol. You can also hold down the two small buttons to continuously cycle between lock and unlock.



When the device is locked, the two buttons will no longer allow you to adjust the power up and down until it's been unlocked. While the device is locked, anytime you press these buttons, the screen will show the locked symbol. The device will still fire when the main button is pressed; you just won't be able to change power settings.

## Screen Layout

You can enter the main menu by pressing the button 4 times. When the menu appears, you will notice there are several icons and options available to include "SET", "RCL", "Info", "Exit". In the following pages, we will walk you through all of the different icons and how each one allows you to select various options.

The top section of the screen shows the scrolling icons.

As the icons go by, clicking the button will select that menu item and take you further into that section. This is where you can make changes as to how the device works or recall profiles.

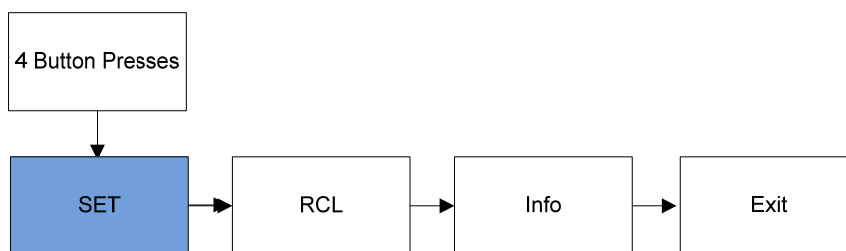

As the icons scroll by, click the power button once when you see the icon you want to select.

## Check All/Status Screen



Pressing the power button once will display your status screen. On the top left of the screen, you will see what power level you are currently at. In this example we are set to 8.8 watts.

On the bottom left we can see our attached tank is reading 1.8 ohms and on the right side of the screen is the battery indicator. The lightning bolt inside the battery icon indicates that you are plugged in and charging the battery. When the battery reaches a full charge or you unplug the device, the lightning bolt indicator will no longer appear.

The Check All status function allows you to quickly see your basic settings on one screen. When this function is turned on (default) one button press will allow you to see all your critical settings.

The Check All Status feature is adjustable or can also be turned off. The available options are OFF, 1 second, 5 seconds, 10 seconds and 20 seconds. These values correspond to the amount of time the Check All display will stay on the screen after you release the button.

If you select OFF, then the Check All screen will not appear when you press the button.

To make changes to the Check All function, visit the menu SET > DIS > TIME. You will have a number of options where you can adjust the Check All Screen.

**Warning System** The Radius has a warning system that alerts you about a problem.

Anytime there is an issue that needs attention, this icon will appear on the status screen. 



In this example, the device is detecting OP (Open) meaning there is no atomizer installed or the atomizer is burned out. Making a correction to fix the problem will automatically reset this warning. If you want to know more details about this warning and how to fix the problem, you can get the details by going to the main menu (4 button presses). As the menu scrolls past the various icons, you will notice at the end of the scrolling icons there is a matching warning symbol that appears before the exit. 

Click the button on this new menu item and the Radius will tell you what the problem is and how to fix it.

Note that after you fix the problem, this temporary menu item will go away and return to the normal set of menu icons.

Any time there is a situation where the desired power level set (based on the ohms of your coil and the set wattage) is not feasible or safe, the Radius will automatically change the system wattage to the highest power level it deems correct - without issuing an on-screen warning. Critical errors necessitating manual changes by the user will be displayed.

## Menu Options and Functions

In this section, we will discuss all the various functions of the ProVari Radius and what they do. While the ProVari Radius is a very powerful device and there are a lot of options, you will find that it's easy to operate and use with a little practice.

Press the button 4 times and you will start the scrolling icons for all the various functions. When you see a function that you want to access, press the button one more time and it will select this menu item.

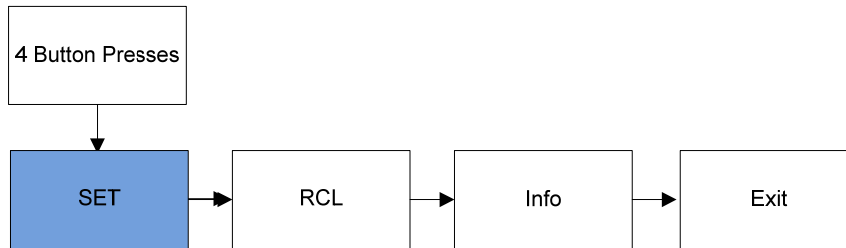

This is the first set of icons that scroll when you first access the menu. The icons for Set, Recall, Info and Exit will scroll on the screen. The menu will scroll twice before automatically exiting the menu system.

Next, we will describe each screen and what you can set in that area.



**Set (Settings)** - In the Set menu there are numerous different settings that allow you to customize the function and appearance of the ProVari Radius. Under the Set category you can save a profile, adjust your display brightness, scroll speed, switch between left and right hand display mode, change the OnTime settings for the Check All function, switch the push button LED On or Off, alter the LED button color and adjust the Boost mode settings.

Once you have selected the Set option, you will be taken to the Set screen where you will see numerous menu options scroll on the screen. You can use the button to select one of the device setting options.

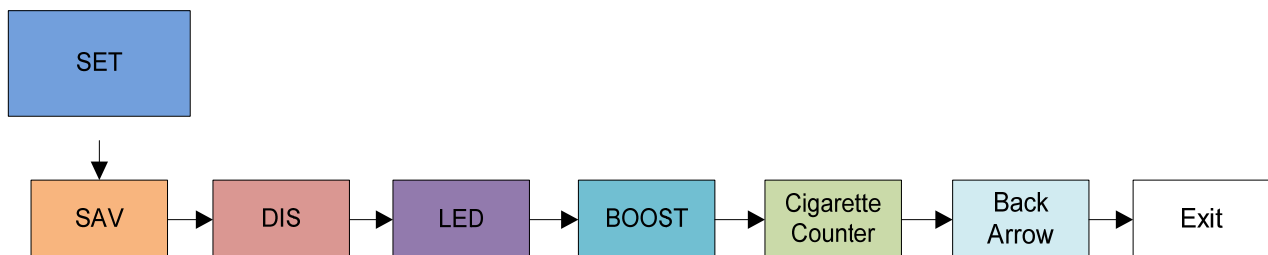

The menu will scroll twice before automatically exiting the menu system.

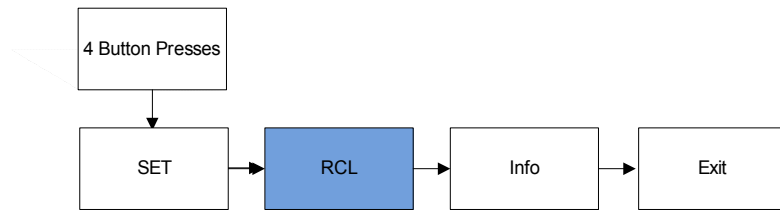

**RCL (Recall)** – Recall allows you to load a saved profile. A profile consists of all of the unique settings in use at a particular time. This makes it easy to retrieve special settings for different e-liquids or accessories.

Later in this manual we will discuss how to save your settings into a profile.

Once you have selected the Recall option, you will be taken to the Recall screen. You can use the button to select one of the five different user profiles.



As you press the button, Profiles 1 through 5 and the Info icon will scroll past. When you see the profile you want to recall, press the button once.

For example, if you were to press the button while “4P” is on the screen, you would recall User Profile #4. After you have selected a profile, the screen will automatically exit out of the menu system after 5 seconds.



If you choose not to recall a profile, you can select the Exit option to return to normal use.



## Info

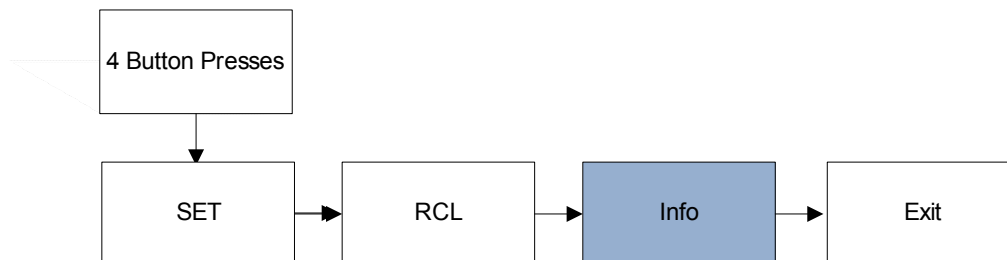

The Info icon provides additional information about your device.

Ver = the version of your software



SN1, SN2, SN3 - This is the digital serial number of your device. The combined three sets of digits creates the full serial number.



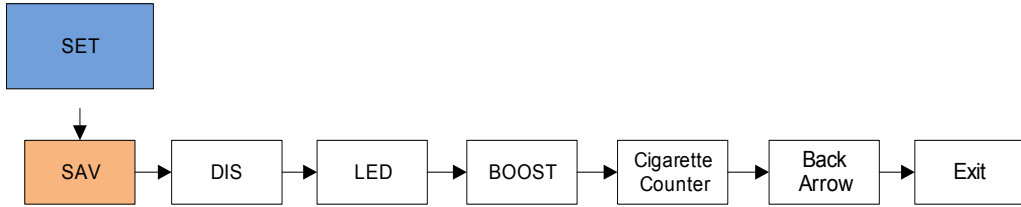

When selecting SET, this will take you into the menu options where you can adjust the master settings for the device.



**Sav (Save)** – Save allows you to save a user specific profile. A profile consists of all of the unique settings in use on the device at a particular time.

The settings you can save include:

- Wattage Level
- Boost level setting
- LED color
- LED On/Off setting
- Display screen brightness
- Display screen scroll speed
- Display screen left or right display
- Check All status screen display time (Time)

This makes it easy to retrieve special settings for different juices or accessories.

Once you have selected the Save option, you will be taken to the Save screen where you can use the button to select one of the five different user profiles.

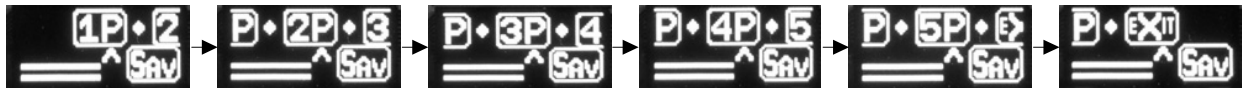

Profiles 1 through 5 will scroll past.

When you see the profile you want to save, press the button once.

For example, if you were to press the button while “4P” is on the screen, you would save User Profile # 4.



If User Profile # 4 already has settings saved in it, they will be replaced with the current settings on the device. Old profile settings are overwritten.

After you have saved a profile, the screen will automatically exit out of the menu system after 5 seconds.

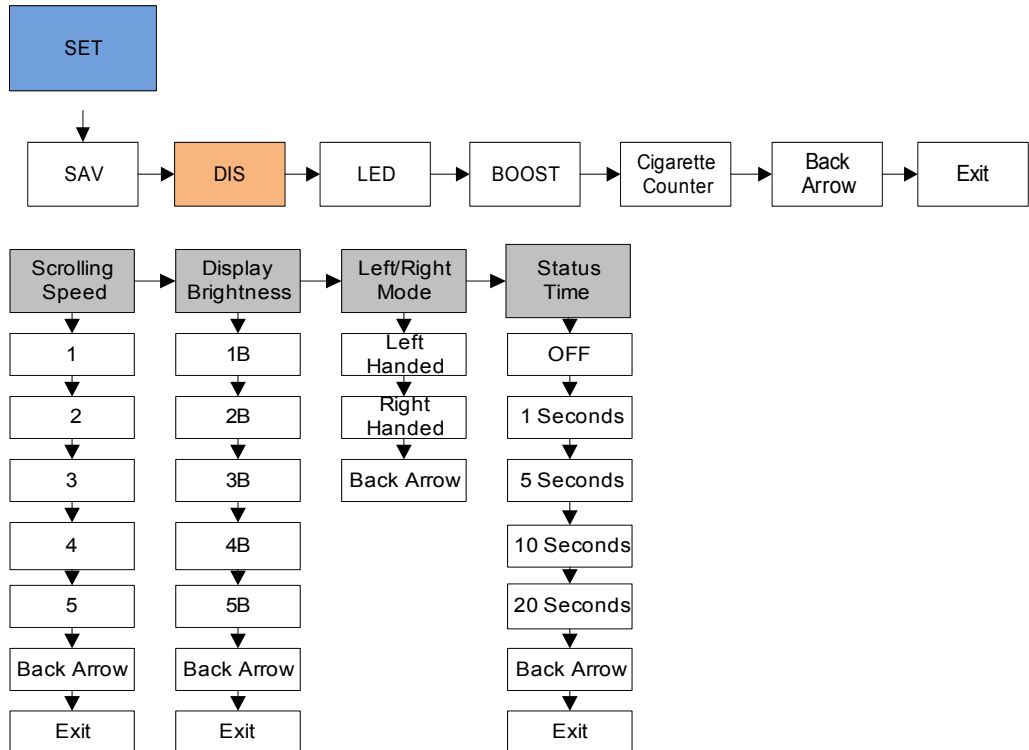

**Dis (Display)** – In the Display menu there are numerous different settings that allow you to customize the appearance of the OLED display. Under the Display option you can adjust your display brightness, scroll speed, switch between left and right hand display mode and change the OnTime/Status Time settings for the Check All function.

Once you have selected the Display option, you will be taken to the Display screen where you will see numerous menu options scroll on the screen. You can use the button to select one of the device setting options.



The icons for Scroll Speed, Display Brightness, Display Right/Left mode and Check All screen Time (time duration) will scroll on the screen.

The menu will scroll twice before automatically exiting the menu system.



**Scroll Speed** - This section allows you to adjust the speed of the scrolling menu.

When entering this menu area, you will be presented with speed selections 1 through 5.



Each time you press the button to select a number, the display will scroll faster or slower depending on what setting you have selected.



In this example, the unit is set to Scroll Speed # 1 which is the slowest speed. If we were to select # 3 the screen would begin scrolling faster.

Once you are happy with the scroll speed, select Exit to save.



**B (Brightness)** – This will change the brightness of the display.

When entering this menu area, you will be presented with brightness selections 1 through 5.

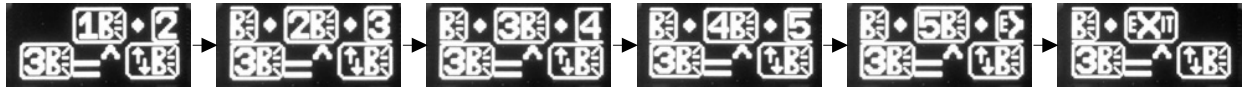

Each time you press the button to select a setting, the display will get brighter or dimmer depending on what setting you have selected.



In this example, the unit is set to display Brightness 3B which is the medium intensity setting. If we were to select 1B, the screen would become dimmer since 1B is the lowest intensity.

Once you are happy with the screen brightness, select Exit to save.





**L/R - Left or Right screen display** – This setting changes the orientation of the display. This feature is used to switch the device for use in either the right or left hand.

As you select the two options, you will see the display flip from left to right handed mode. In this example, if we were to select the icon on the screen, the display would flip upside-down.



Once you are happy with the screen orientation, select Exit to save.



**Time** – This setting controls the Check All status screen duration. The status screen shows all the critical data with a one button press. Battery capacity, atomizer ohms and wattage settings are displayed.

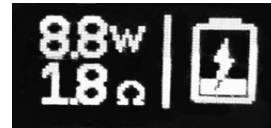

In this menu, you can turn this feature off or change the duration of the Check All status screen to 1, 5, 10 or 20 seconds.



Click the button to select the time duration you want. In this example, the current setting is 5 seconds. If we were to select the icon on the screen, we would change the Time duration to 10 seconds.



Once you select the option you want, select Exit to save.

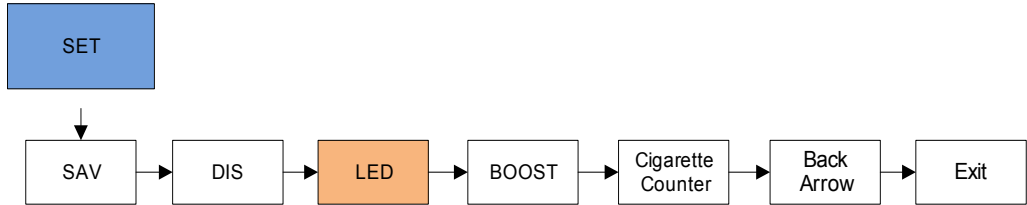

**LED Menu** - This menu section allows you to turn the LED button on and off and lets you change the color of the LED button.

Once you have selected the LED option, you will be taken to the LED screen where you can select either the LED On/Off option or the LED Color option.



The menu will scroll twice before automatically exiting the menu system.



**On/Off – LED Button On/Off Option.** This toggles the LED button on or off. When you press the button to heat up your atomizer, if the LED is turned on, then the button will light up the color of your choice. When this function is turned off, the LED button will not turn on.

When you see the setting you want, press the button once to select it. After 5 seconds, the screen will automatically exit out of the menu system.



If you choose not to change settings, you can select the Exit option to return to the previous menu level.



**C – LED Button Color** – The LED color selection allows you to change the color of the LED button. Available options are red, green, blue, aqua, yellow, pink, white or random.

Once you have selected the C option, you will be taken to the LED Button Color screen, where you can select any of the optional button colors. When you enter this menu, the button will light up and show you all the different colors as it rotates through the different selections.

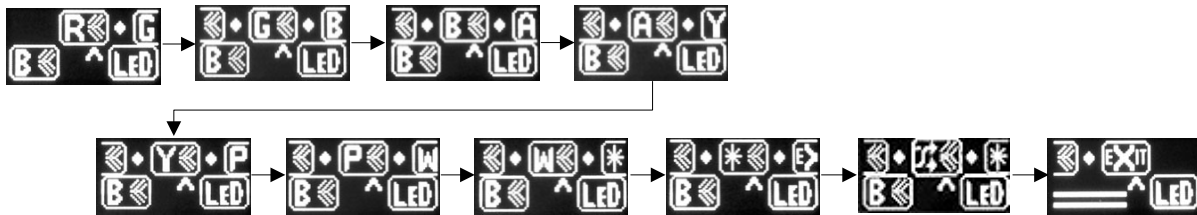

When you find a color you like, simply press the main button once and that color will be selected. In this example, the color “red” has already been selected. If you were to press the button to select the current icon “G”, the button color would be changed to “green”.



To save that color, select Exit.



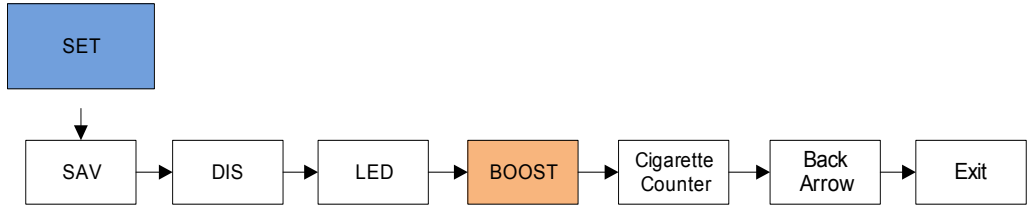

**Boost Menu** - This menu section allows you to turn the Boost Mode On and Off and lets you change the duration of the Boost.

- Boost 1 - .25 seconds
- Boost 2 - .50 seconds
- Boost 3 - .75 seconds
- Boost 4 - 1.00 seconds
- Boost 5 - 1.25 seconds

Once you have selected the Boost option, you will be taken to the Boost screen where you can set the Boost mode Off or set the Boost mode duration which automatically turns Boost mode On.



The menu will scroll twice before automatically exiting the menu system.

For example, if you set your wattage to 9 watts, then turn on boost mode 2. When you press the button, the device will boost the power for the first .5 seconds and then it will drop down to 9 watts.



Increasing the boost level to 2, 3, 4 or 5 will increase the amount of time the device boosts the power before it drops down to your selected 9 watts.

Note that turning the ProVari Radius up to max wattage and boost up to 5 will not exceed the maximum output of the unit which is up to 40 watts. Boost will give you a 5 watt increase all the way up to 35 watts, which hits the 40 watt limit.

Once you select the option you want, select Exit to save.



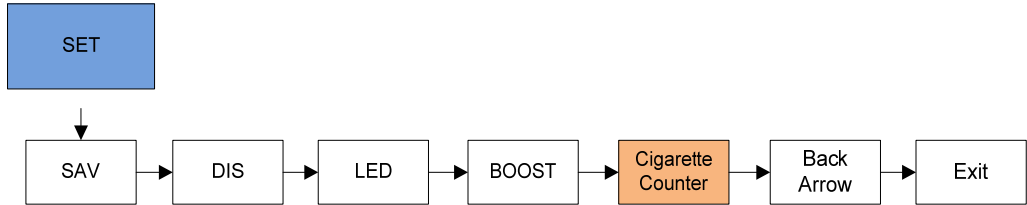

## Money Saved Counter - Cigarette Counter

This feature calculates money saved, cigarettes avoided and vape counter.



In the SET menu you will see this cigarette icon. Selecting this will take you into the settings and information for the Money Saved area.



Money Saved - The first icon is a money saved status. Based on the dollar per pack that you set in the below settings and the number of puffs, we calculate how much you have saved. Each time you take a puff on the RADIUS, it will keep track and update this as you go.

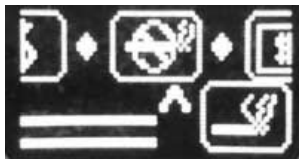

Cigs Avoided - Selecting this icon will show you the number of cigarettes avoided.

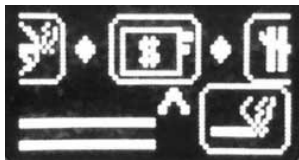

Price Per Pack - Selecting this icon will allow you to set the price per pack. If the cost of a pack of cigarettes in your area is \$10, then set this to \$10. This will allow the other calculators to figure out money saved.



Puff Count - This icon when selected will show the total puffs on your ProVari. This number can be changed by pressing or holding the ProVari button. If you want to add puffs to calculate your usage before this feature was added, hold the button down until you reach the desired count. If you exceed the number where you want to be, simply hold the main button down and the puff counter will count all the way up to 999,999 then cycle back to 0 and you can start over until you get your count where you want it.



## Error Messages and Fixes

| Error Message   |     | Suggested Fix                            |
|---|-----|--|
| OUTPUT TOO HIGH OR BAD ATOMIZER [1]                           | >>> | REDUCE VOLTS / WATTS OR REPLACE ATOMIZER |
| OUTPUT CURRENT HIGH [2]                                       | >>> | REPLACE ATOMIZER AND TRY AGAIN           |
| OUTPUT TOO HIGH [3]   | >>> | REDUCE VOLTS / WATTS                     |
| TEMPERATURE HIGH [4]  | >>> | LET COOL AND REPLACE BATTERY             |
| TEMPERATURE HIGH [5]  | >>> | LET COOL AND REPLACE BATTERY             |
| OUTPUT FAULT [6]  | >>> | RETURN FOR REPAIR                        |
| OUTPUT FAULT [7]  | >>> | REPLACE ATOMIZER AND TRY AGAIN           |
| INTERNAL FAULT [8]  | >>> | RETURN FOR REPAIR                        |
| INTERNAL FAULT [9]  | >>> | RETURN FOR REPAIR                        |
| BATTERY VOLTS HIGH [10]                                       | >>> | USE CORRECT BATTERY                      |
| OUTPUT TOO HIGH OR BAD ATTY [20]                              | >>> | REDUCE WATTS                             |
| INPUT QUALITY POOR / BAD - OUTPUT LIMITED [30]                | >>> | CHECK BATTERY, CONTACTS AND SPRING       |
| LOW INPUT VOLTS DUE TO POOR INPUT QUALITY OR BAD BATTERY [34] | >>> | CHECK BATTERY, CONTACTS, AND SPRING      |

## Error Message Details

In the event that you get an error message, the Radius will alert you on screen as to the reason for the error and the suggested fix. Below is a list of the error messages that can occur.

**Check Battery, Contacts and Spring** - This can happen if you are using a bad battery or the spring is not making a good connection with the battery. This can usually be fixed by removing the end cap and adjusting your spring, checking that all your contacts are clean and then reinstalling the end plate.

**Reduce Watts or Change Atomizer** - If the atomizer ohms are too high or your output wattage is set too high this error can occur. Try lowering the power level or change your atomizer.

**Increase Watts or Change Atomizer** - There are situations where you need to increase the watts. For example, if you set the device to 3 watts and try to use a low resistance atomizer, the device cannot drive power at that level. This scenario will prompt this error.

**Reduce Watts or Replace Atomizer** – This error can occur if the wattage is set too high and Radius cannot safely power the atomizer with your current settings. This can also happen if you have the wattage set too high along with the boost mode set too high. Try lowering your settings. Most of the time, if you have these power settings too high, you will be burning the juice and it won't taste very good or you risk burning out your atomizer.

**Replace Atomizer and Try Again** – This can happen if the resistance of your atomizer is too low or has failed. Anytime the resistance of your atomizer drops, in most cases, it has burned up or failed. This can also occur if you make your own coil on a RBA and you go below the resistance level that is safe. Typically this is anything below .3 ohms. Try installing a new atomizer and see if the problem goes away.

**Let Cool and Replace Battery** – While these are very rare error messages, the system is monitoring for an unsafe condition with your battery. If your battery ever gets too hot and it's not safe to use, carefully remove the battery and properly discard. If the unit is too hot, it's best to set it down and wait for it to cool off before removing the cell. Anytime you have a battery fail, always discard the cell and replace it with a new one. Never try to recharge or reuse a bad battery. Also remember to always use the correct batteries in the Radius.

**Return for Repair** – If you get this error, try installing a new battery and replace the atomizer to see if the problem goes away. If you continue to get this error, contact customer service for assistance.

**Use Correct Battery** – This error will occur if you try to stack two batteries together or you use the wrong battery. Replace your battery or only use one cell and try again.

## Radius Energy Gauge

### What is Different about the ProVari Radius Available Energy Display?

The Radius Available Energy Display is not like any other battery meter you have seen before for several reasons. This section will explain why it is so different.

All other devices in use today that use a battery and have some sort of a "power gauge" have low current drain loads (cell phones, tablets, MP3 players).

Low current drain loads take a small amount of energy out of the battery in each use cycle or continuously take a small amount of current out of the battery. The amount of energy drain is typically less than ½ watt. Also, the current used is typically consistent, meaning it is close to the same all the time. In addition, these devices typically have a captive battery (one that you cannot replace) that is a controlled component that is not changed. This is NOT the case with the Radius.

Because of this, ProVape engineering has designed a special energy gauge algorithm to be more useful to the Radius user. It displays the true gauge of available energy more accurately.

The following factors are used in the special algorithm that allows the energy gauge to be more accurate.

- 1) The lithium ion battery can supply more energy to the atomizer if its rest time between uses is longer AND will supply less energy if the rest time is shorter.
- 2) The battery can supply more energy if the use current is less and uses less energy than if the use current is larger.
- 3) All batteries are different. There is a huge difference between one brand and another. The battery capacities and internal resistances can be significantly different, as much as 40% to 50% between brands. Capacities and internal resistance can be +/- 15% difference between batteries even within the same brand. And to make it even more complex, each time you use a battery, its capacity and internal resistance will degrade and change. This is why after 200 to 300 charge/discharge cycles, the battery capacity will be down to 75% - 85% of what it was when it was new. Beyond 300 charge/discharge cycles, the capacity will degrade at an even faster rate.
- 4) The Available Energy can also be affected by the quality of the end cap tightness, the end cap spring and any corrosion on the battery contacts including the positive and negative battery surfaces. These contact surfaces are much more sensitive because of the high current drain used by the Radius. To heat an atomizer to the temperatures needed to vaporize the e-liquid can require currents in excess of 3 to 4 amps. Very few, if any, alternate hand-held devices use this kind of power in their application.

When considering these factors in this unique application, ProVape engineering has designed the energy gauge display of Available Energy to provide a more TRUE display. Because of this, it will work differently than what you are used to using. It will work differently in the following ways:

- 1) When a battery is initially installed, the energy gauge will display "???" instead of a meter for approximately 1-2 button presses. It is arriving at its initial estimate of the battery's Available Energy. Remember, the battery you install may not be fully charged. It has to determine what is the initial state of charge.
- 2) Each time you press the button to use energy from the battery, it makes a new estimate using all the factors above.
- 3) The energy gauge displayed could go up or down. That is TOTALLY different from other power gauge displays but perfectly normal for the Radius. It is important to remember that the Radius power gauge is NOT displaying the amount of energy that is in the battery but instead, the amount of Energy that is Available to the atomizer. This can change from button press to button press depending on the factors described above. An analogy is to compare the miles you can get out of a car gas tank. You will get more miles if you drive slower because the air friction is less. But, at the same time, realize that a battery is a completely different kind of chemical energy supply system compared to the chemical energy in a car fuel tank. You will get more uses out of a battery if you let it rest longer between button presses. This is NOT the case with the fuel in a car's fuel tank.



ProVape Inc.

© 2015 ProVape Inc. All rights reserved.

ProVari, the ProVari logo, and ProVape Radius name and logo are trademarks of ProVape Inc, registered in the U.S. and other countries.

Mention of third-party products is for informational purposes only and constitutes neither an endorsement nor a recommendation. ProVape assumes no responsibility with regard to the performance or use of these products. All understandings, agreements or warranties, if any, take place directly between the vendors and the prospective users. Every effort has been made to ensure that the information in this manual is accurate. ProVape is not responsible for printing, clerical errors or updates to the manual or functionality that may happen after the manual has been distributed. Please use product at your own risk.

## **Additional Warnings**

1. Keep all directions for future use and use only as instructed.
2. This product is for smokers only and is not intended for non-smokers.
3. Electronic cigarettes, personal vaporizers, e-liquid are not are not approved by the FDA.
4. This product is not a smoking cessation device nor is it intended to be one. If you are trying to quit smoking or vaping please consult your doctor.
5. You must be of legal smoking age in your jurisdiction to use this product.
6. Do not modify or attempt to disassemble this product. Use according to instructions.
7. Do not attempt to fix, correct, replace or install any part of the vaping apparatus, see you seller.
8. Do not drink the e-liquid, or puncture the cartridge and keep away from children and animals.
9. Expect to have variances of the ingredients and nicotine levels. Exact amounts are not guaranteed.
10. Do not use while driving

11. Vape away from the vicinity of people and pets. The effects of second hand vapor have not been scientifically confirmed. However, Propylene Glycol is an allergen and Nicotine is known to cause reproductive harm.
12. Use this product in moderation. Failure to do so may nicotine overdose which can lead to an irregular heart beat and other symptoms listed below.
13. Drink at least 8-cups of water daily.
14. Flavorings in the e-juice may contain trace amounts of nuts, gluten, sugar, or other sweeteners. Flavorings may also contain artificial colors, artificial flavors, and artificial sweeteners.
15. Vaping flavorings may cause respiratory illness, disease, or symptoms.
16. Do not mix different brands or flavors of e-liquid, as doing so may result in injury.
17. Do not use this product if you are allergic or sensitive to any of the ingredients such as Propylene Glycol, Vegetable Glycerin, Nicotine, and food flavoring.
18. This product contains Nicotine, an addictive chemical known the State of California to cause birth defects or other reproductive harm. Other chemicals are present which cause cancer and respiratory disease. Toxic if spilled on skin or ingested. Dispose according to local or state law. Not for persons under the legal smoking age, with allergies, pregnant or breastfeeding women, anyone with any existing medical conditions or pets. May aggravate or cause other disease. Not a smoking cessation product.
19. Additional Nicotine warnings: Nicotine is a highly addictive substance and can be poisonous with serious health consequences including death. You should not use this product if you have any underlining medical conditions which may be aggravated or exacerbated by this product. You may experience symptoms after using this product. Some of the side effects of nicotine may include irregular heartbeat, changes in blood pressure, inflammation of blood vessels, chest pain, and depression, shortness of breath, sweating, dizziness, dry mouth, throat irritation, rash, swelling, nose bleed, diarrhea, headache, and dry mouth. Consult your physician prior to using this product. Nicotine is quickly absorbed with skin contact. Keep away from skin, eyes, mouth, and any other area of the body. In the event that you become in contact with nicotine, wash the affected area with soap and water for at least 15 minutes, and immediately contact your local Poison Control Center.
20. Drug interactions: Nicotine may interact with certain pharmaceutical drugs. Consult your physician or pharmacist prior to use to avoid serious complications.
21. Do not use in conjunction with illicit drugs, alcohol, energy drinks, herbal, nutritional, and/or nutraceutical supplements.
22. Do not use before, during, and after exercising.

23. Children and Pets: Keep away from children and pets. Small parts and or e-juice may be ingested and may lead to suffocation, injury, poisoning, and/or death.
24. Do not dispose of in trash containers nor litter the environment. Please recycle.
25. Propylene Glycol is poisonous to aquatic animals.
26. Not for use by woman who are nursing, pregnant, or are planning to get pregnant.
27. Vaping and exposure to vaping may potentially cause the emergence, contraction, contribution to, aggravation or exacerbation of various forms of adverse health effects including but not limited to cancer, heart disease, arteriosclerosis, cancer, carcinoma, liver disease, respiratory disease or illness, cancerous or precancerous abnormal condition or conditions, disorder, sickness, ailment, unhealthiness, symptoms, diseases, illness or malady of the human body.
28. Consult your doctor prior to use of this product.
29. **Battery Warnings** : Lithium-ion batteries are volatile. They may burn or explode with improper use. Do not use or charge with non-approved devices. Overuse of vaping apparatus may cause this product to overheat, malfunction, and/or may cause burns.
30. Do not leave this product unattended while charging anytime or overnight, and do not charge it in your vehicle.
31. Keep away from high heat, direct sunlight, cold temperatures, humidity and water. Injury or death can occur.
32. Do not replace batteries with non-approved units.
33. Do not mix new and used batteries or different brands.
34. When charging keep away from flammable areas such as but not limited to wood floors and carpets. Always use a fire resistant container or bag.
35. Always have a fire extinguisher in an event of a fire.
36. If battery or device looks damaged, do not use.
37. Do not expose the battery to direct sunlight.
38. If you witness the battery starting to balloon, swell up, smoke, or become very hot. Immediately disconnect the power to your home or office from the circuit breaker. If a circuit breaker is unavailable, disconnect from outlet. Do not approach the battery for at least 2 hours and make sure that the room is ventilated.
39. Never drop, damage, or tamper with the batteries.

40. Never attempt to charge directly from the wall outlet. Always use a surge protector.
41. Do not throw batteries into fire.
42. Do not connect improperly.
43. Do not use any charger other than the one provided to you to charge your device
44. Do not charge batteries unless are specifically labeled as “rechargeable”.
45. Do not carry or store batteries together with a metallic necklace, in your pockets, purse, or anywhere else where they may become exposed to metals.
46. Keep away from children and pets. Should a child/pet swallow or chew on a battery, immediately consult a physician and or call your local Poison Control Center.
47. Always turn off your vaping apparatus in between uses.
48. Unplug the charging apparatus in between uses.

Failure to follow warnings may result in electric shock, fire, property damage, bodily injury, or death.